



5013236200

PPM R1E Power monitor Installation manual

• Below said level of risk occurs when improperly used.

WARNING !

Do not open this product or insert tools due to shock and fire hazard which may cause injury.

When installing this product you must adhere to the following instructions:

- Do not power up the device before installation is complete.
- All circuit breakers must be in the OFF position before commencing installation.

- Unsuitable installation locations which will void the product warranty:

- Do not install in direct sunlight.
- Do not expose to high humidity.
- Install in a safe place where it is inaccessible for children .
- Do not install in poorly ventilated area.
- Do not expose to water vapor, oil vapor, smoke, dust, salt, corrosive substances, explosive / flammable GAS, chemicals.
- Do not install above 1000m mean sea level.
- Do not expose to extreme temperature fluctuation.
- Do not expose to high levels of noise, electrical noise.
- Do not expose to vibration.
- Not suitable for installation in medical equipment, communication equipment, marine, automotive.

DANGER!

- Do not work on electrical installation when standing on wet ground.
- Power monitor is a precision electronics. Please handle with care!
- Do not use product if insulation of any wire is broken.

1. System diagram

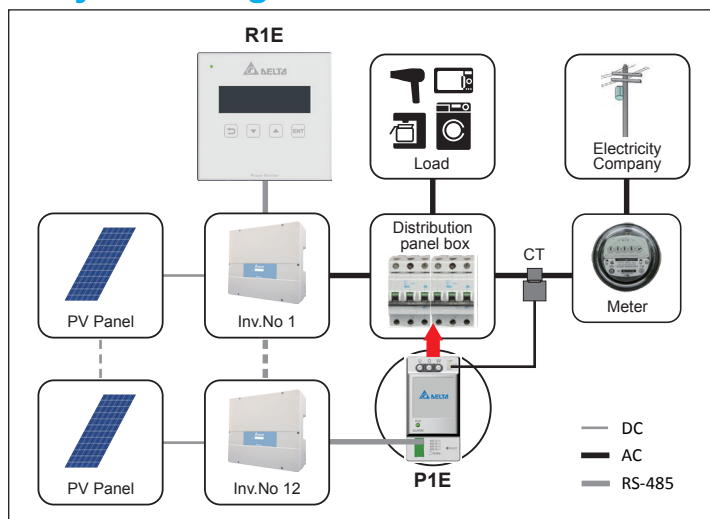

2. Hardware Specifications

Category	Item	Description
HW spec	Rated Operating voltage	12Vdc
	Operating voltage range	12Vdc ~ 16Vdc
	Power Consumption	< 1 Watt
Regulatory	Safety Standard	EN 62109-2 CE compliance
	Emission	EN 55022 class B
	Immunity	EN 61000-6-2
Information	LED Indicator	Green LED Flash Inverter no output power
		Green LED On Inverter generating power
		Red LED Flash Communication error between Inverter
		Red LED On Inverter Error / Fault
	LCD Display	Today energy Day / Month / Year energy log Setting Power limit
Communication	RS-485 Communication	Delta Protocol
Connection	Wired	4 pin terminal block for RS-485
Environment	Operation temperature	-20°C ~ 50°C
	Storage temperature	-20°C ~ 60°C
	Relative humidity	30% ~ 85%
Dimension	Height	115 mm
	Width	120 mm
	Depth	21.3 mm
	Weight	160 g

3. Product appearance

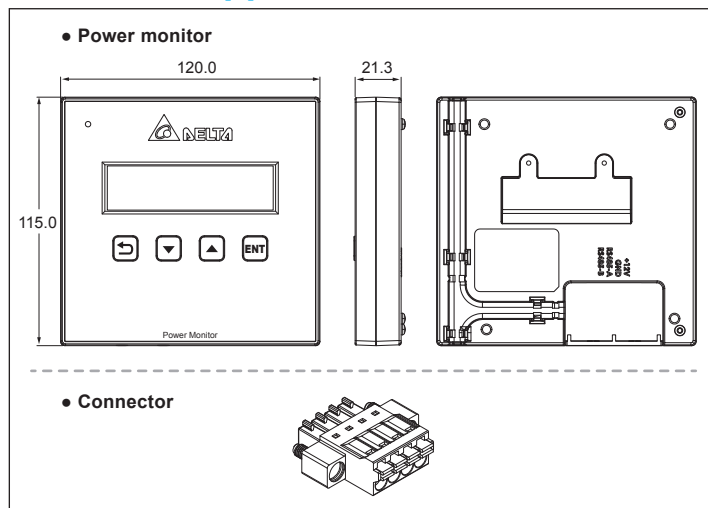

4. Connector setup

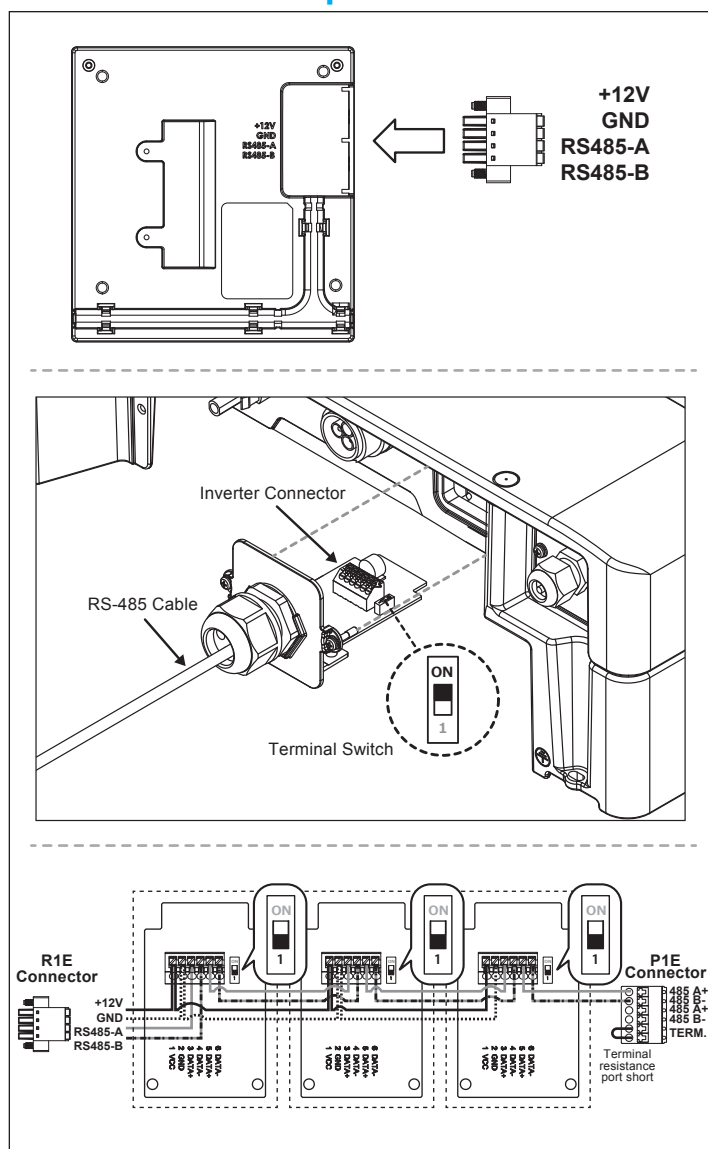

5. Wall Mount

