

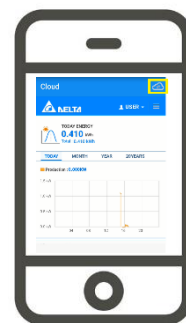

## MY DELTA SOLAR APP

Delta Electronics Australia - How to connect your Inverter to the  
MyDeltaSolar Cloud



Author: Geordie Zaphiris  
[Geordie.zaphiris@deltaww.com](mailto:Geordie.zaphiris@deltaww.com)



## Contents

Document History .....	2
How to connect your Inverter to the MyDeltaSolar Cloud.....	3

## Document History

Revision	Note	Written	Checked	Date
<b>A1.1</b>		GZ		20/08/2019

APP	Inverter	DSP	COM	Date
<b>V1.29a</b>	H5A_222	2.00	2.04	12/06/2020

## How to connect your Inverter to the MyDeltaSolar Cloud

1. Go to the IOS or Google Play store and download the “My Delta Solar” App.

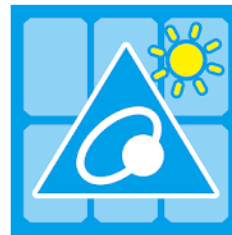

MyDeltaSolar

DELTA\_App.tn Tools

3+

2. Please turn off your mobile data and connect your phone to the home Wi-Fi internet connection closest to the inverter.

Swipe from the top of the screen down



Swipe from the top of the screen down again



Tap on mobile data to turn it on/off. (symbol is black and white when off)  
Connect the phone to the home Wi-Fi

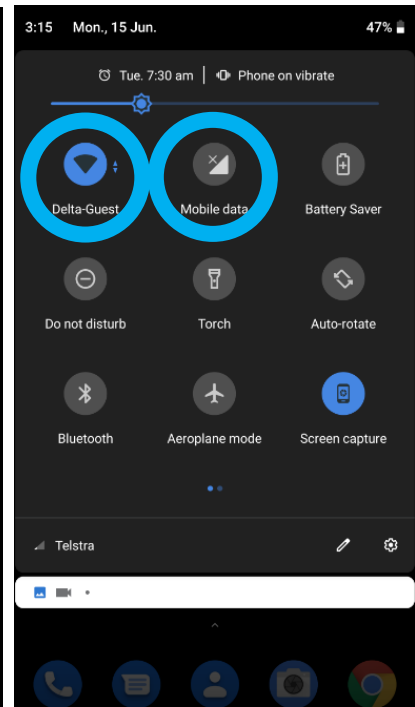
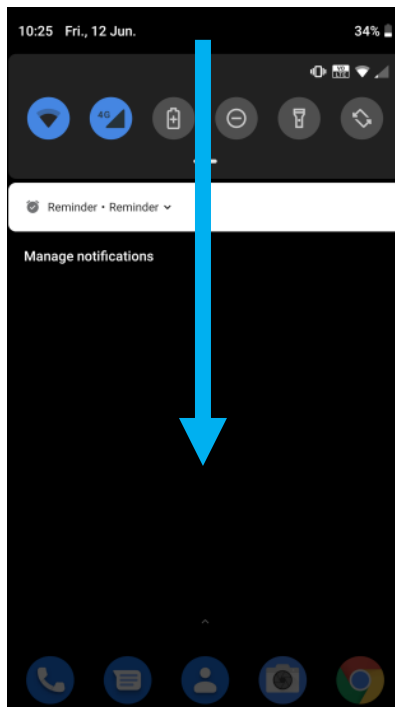
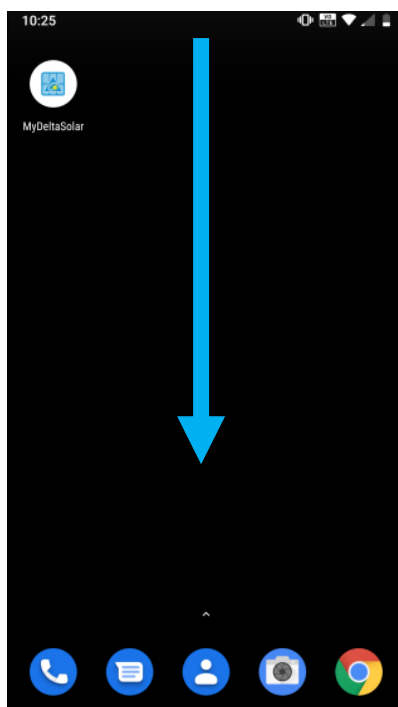



### 3. Launch the app and type in your details to Sign In.

Tap on the  
MyDeltaSolar APP

Fill in your email and  
password and Tap on  
"SIGN IN"

Tap the magnifying  
glass button.

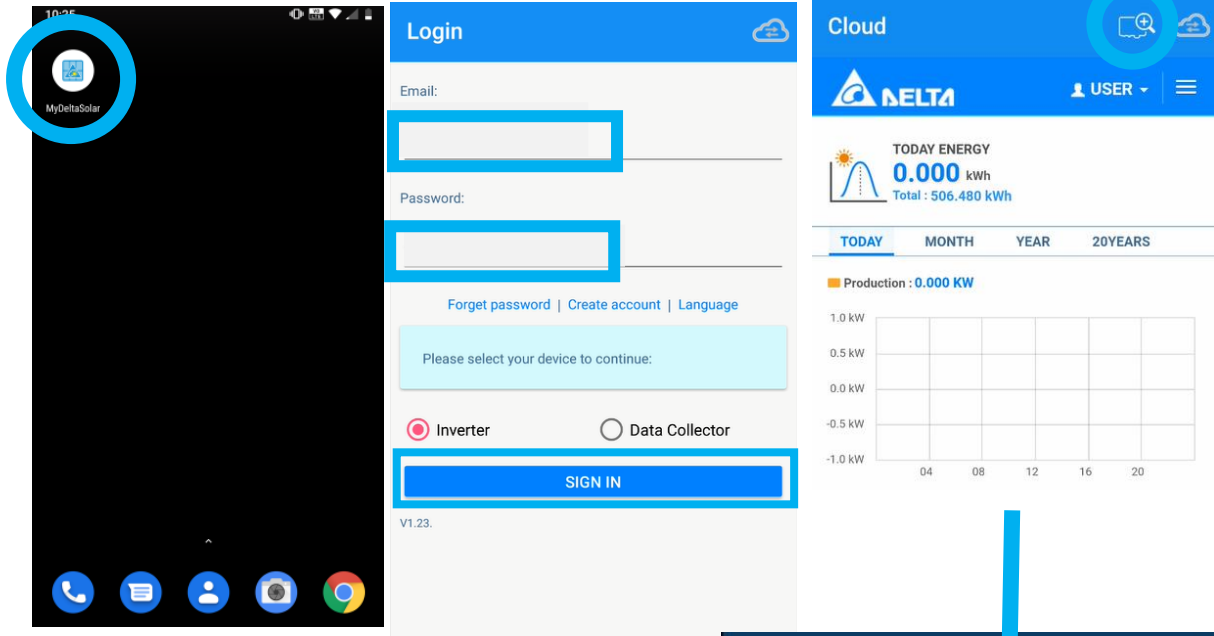

### 4. Press "New Plant". This will be treated as a new installation at a site, multiple inverters can be added to this site. Fill in a plant name, select australia as country and press the "GET" button for location. Then press "SET".

**New Plant**

\*Plant Name: 1 - 16 characters

\*Country: Select Country

\*Location: ☐ No ☒ Yes **GET**

**SET**

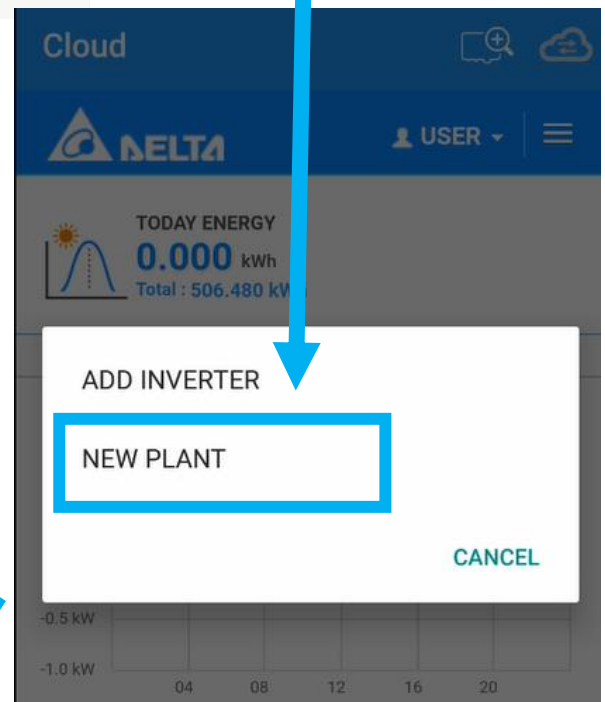

- Press “OK” and your screen will swap to the Wi-Fi screen. Connect your mobile device to the Wi-Fi of the inverter using the default password: DELTASOL. Then return to the App (use the return button at the bottom of the phone on Android devices)

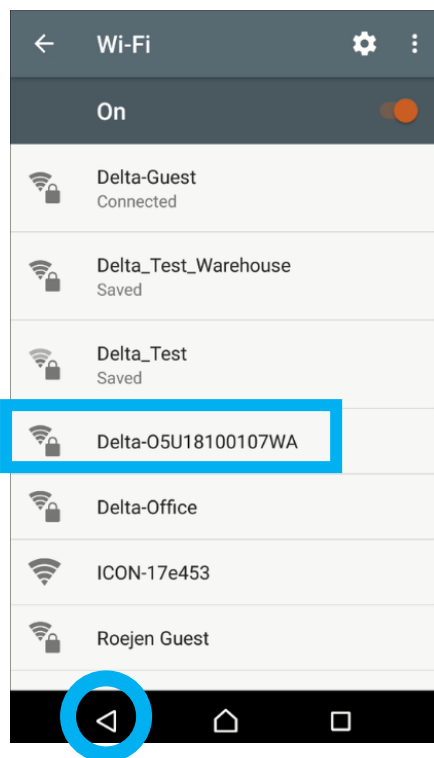

Button to return to App using Android phone

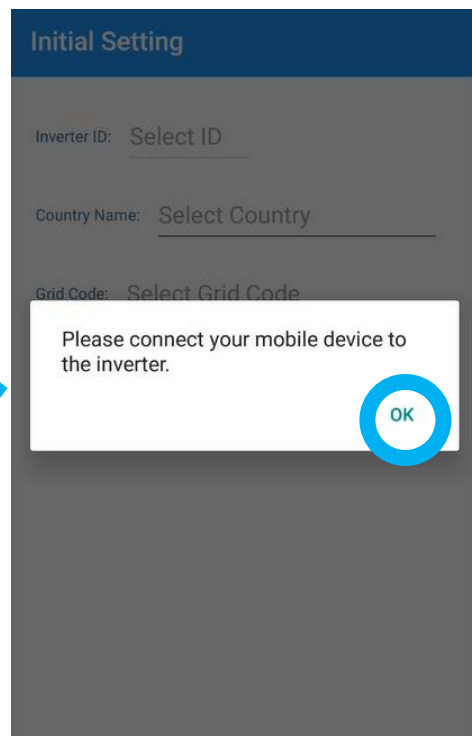

Wi-Fi name: DELTA-SN  
Password: DELTASOL

- After pressing the back button, please select the appropriate grid code for your area and press “SET”.

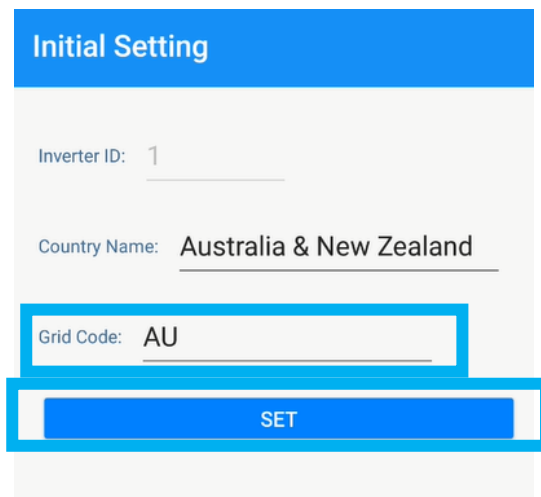
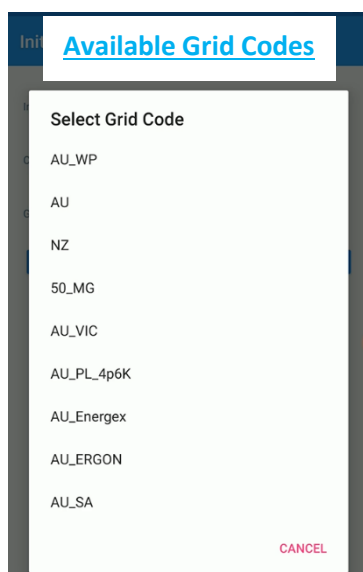

7. Read the terms and conditions, scroll down and press the tickbox to agree.  
Press "OK"

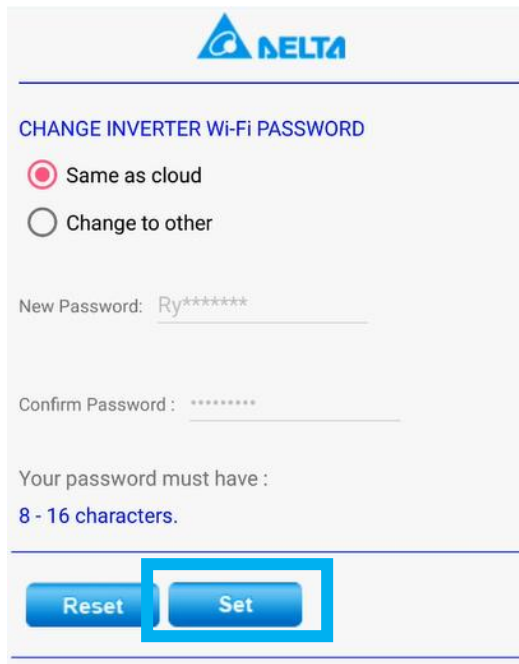
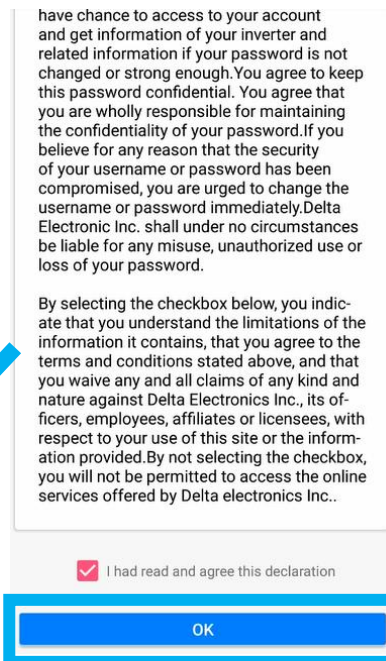
8. Press "Set" to change the inverter password to your cloud account password. (Inverter Wi-Fi password is no longer DELTASOL)

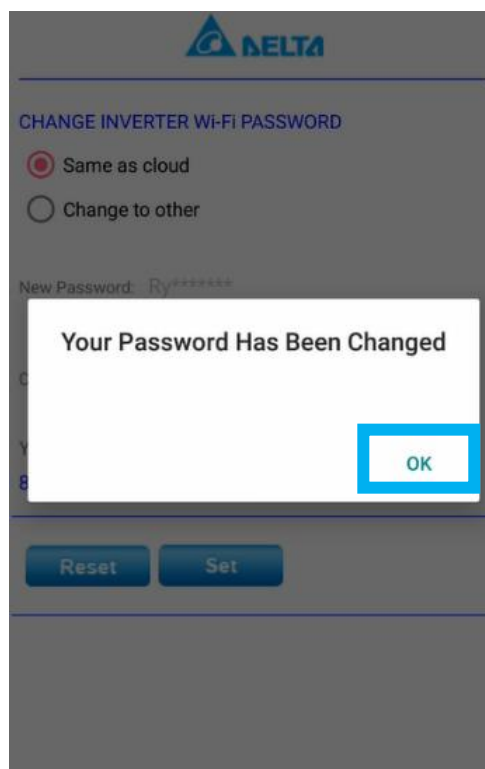

9. Press the “Scan” button and wait for the scan to complete.

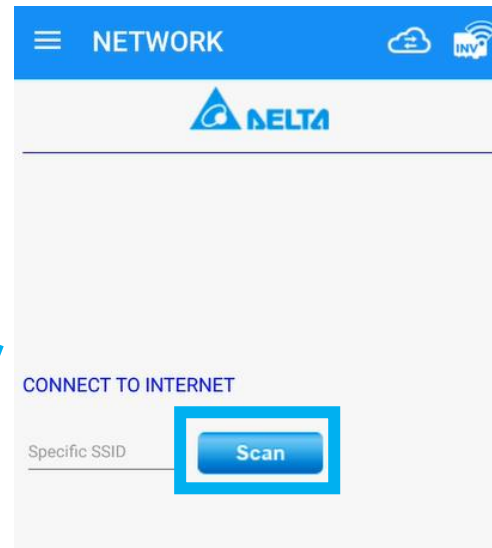
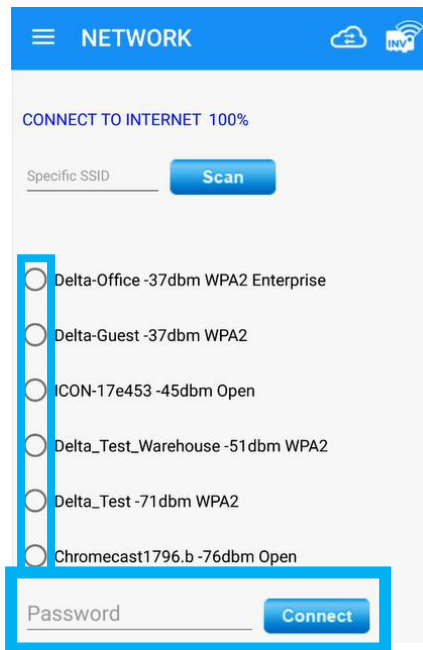

10. Select the Wi-Fi signal to connect your inverter to.

(-60dbm is a good signal and -70dbm is a weak signal, make sure you are connecting to a good signal)

*If there are no suitable Wi-Fi connections, consider moving the router closer or using a Wi-Fi extender. Inverter information such as production can be viewed in point to point mode without internet.*

*If the Wi-Fi strength is too weak (weaker than ~-70dbm) the App will still attempt connection, the outcome will be displayed in a message popup box.*

Select the Wi-Fi Connection and type in the Wi-Fi password then press “Connect”.



After pressing connect, please follow the prompts below.

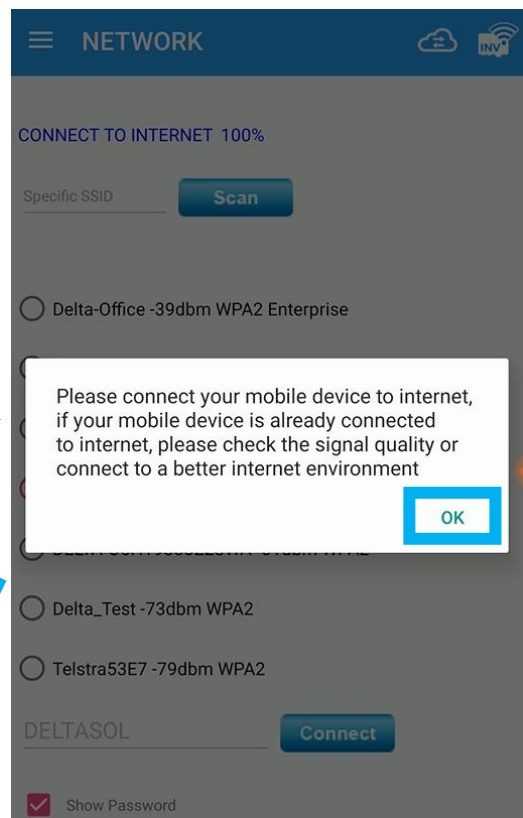
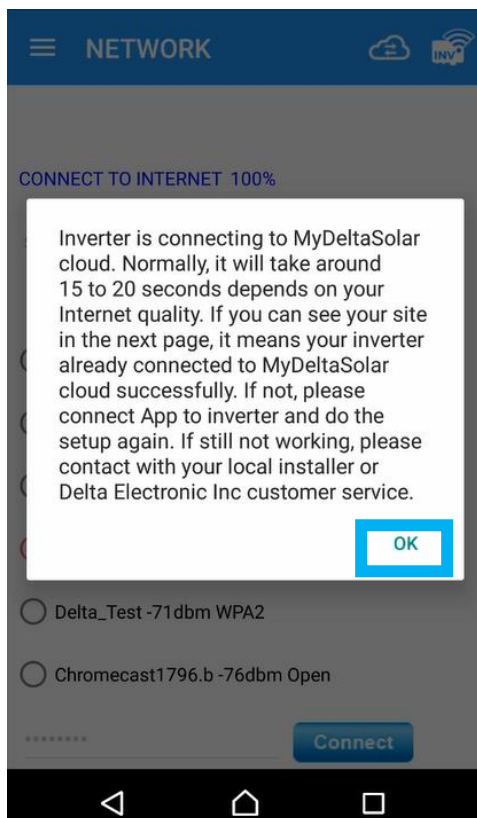

11. Press ok and Disconnect your phone from the inverter Wi-Fi and Connect your mobile Wi-Fi back to the home internet and await the below message.
- When successful you can now login and monitor your inverter power production online.

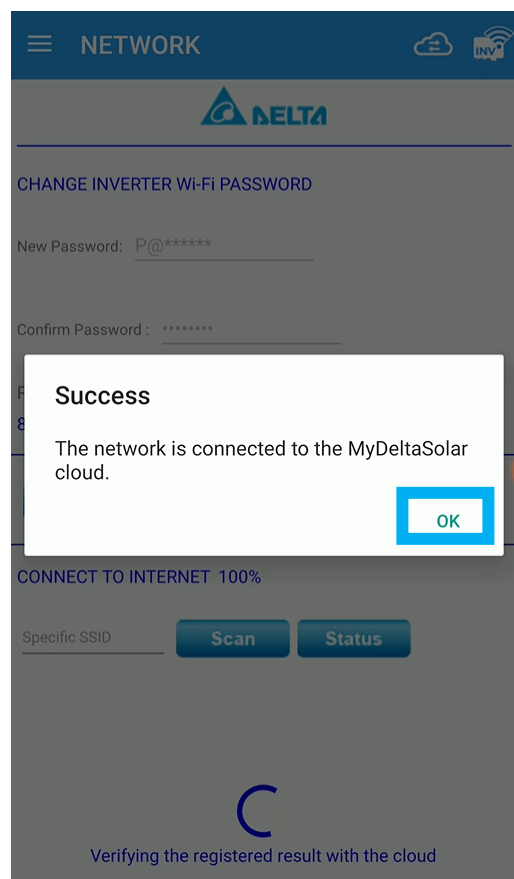

If you have the optional extra CT clamp and cable for consumption monitoring please see our website on how to turn on the internal meter:

[http://support.delta-es.com.au/knowledgebase/h5a\\_222-internal-meter/](http://support.delta-es.com.au/knowledgebase/h5a_222-internal-meter/)

Please also see our H5A\_222 FAQ:

[http://support.delta-es.com.au/knowledgebase/delta-h5a\\_222-faq/](http://support.delta-es.com.au/knowledgebase/delta-h5a_222-faq/)

Don't hesitate to call our support line on 03 8546 3080 for any further questions.