

# Update FW by USB

DA02\_v1.0



USB		USB flash drive format should be FAT/FAT32
-----	---	--

Put the firmware file provide by service team in the USB root path. Take update CHAdEMO CSU FW for example

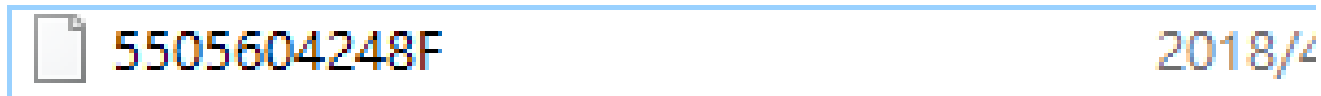

If put mutiple FW at once, ex CHAdEMO CSU FW and Relay control board FW, system will process one by one automatically

1. Insert the USB flash disk into the USB port on the bottom of the unit

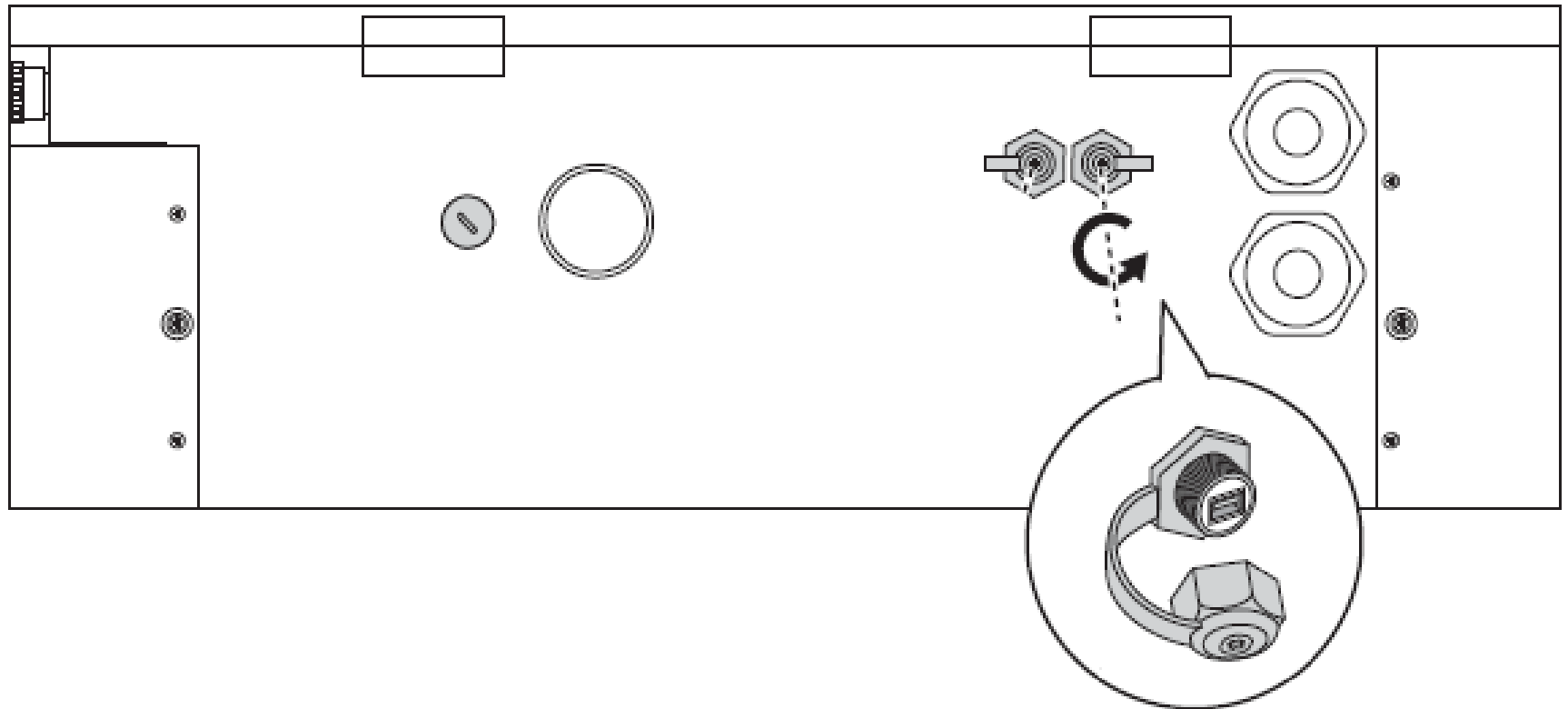



- 1.The firmware(s) will be uploaded to the DC Wallbox once USB insert
- 2.Check the screen for progress updates
- 3.When system finishes firmware(s) update, please unplug USB
- 4.System will restart automatically

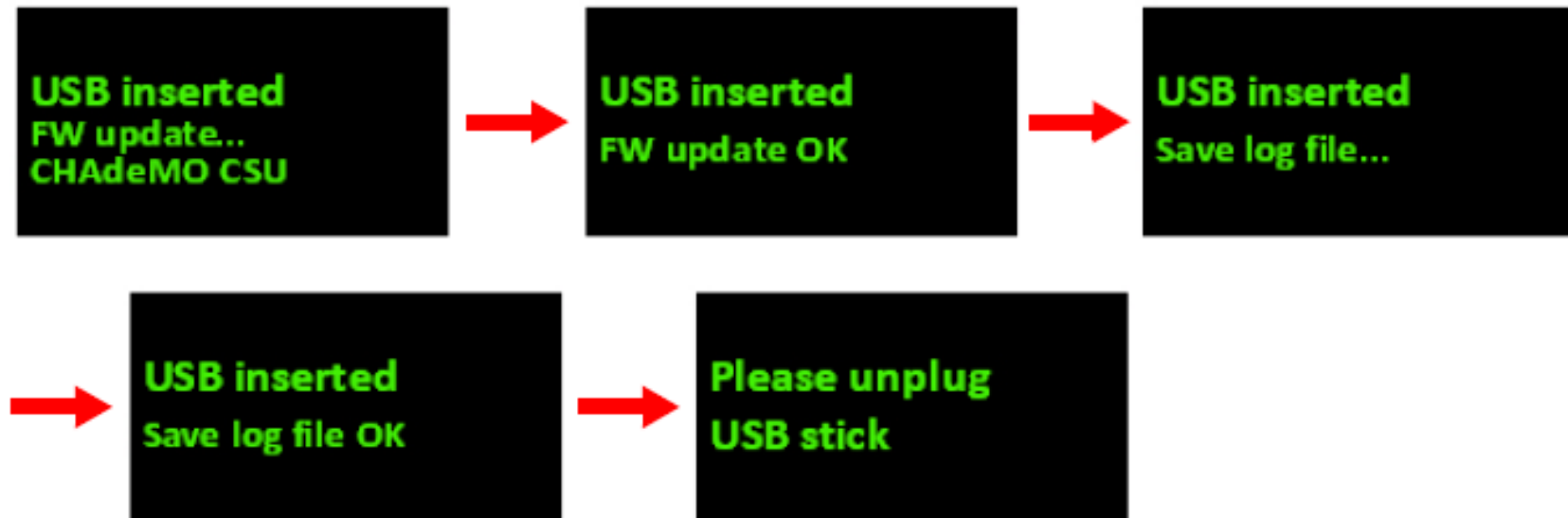

# Smarter. Greener. Together.

To learn more about Delta, please visit [www.deltaww.com](http://www.deltaww.com).

